



UDUPI COCHIN SHIPYARD LIMITED

UDUPI COCHIN SHIPYARD LIMITED

Ministry of Ports, Shipping and Waterways,
Government of India

CONTRACT CELL DEPARTMENT

CORRIGENDUM - I

Tender No.: UCSSL/CC/T/CIVIL/311

Date: 06-01-2025

Sir,

CORRIGENDUM-I – TENDER FOR MOVABLE SHED FABRICATION & ERECTION WORK

The following changes are made in the above subject tender.

1. Tender opening date;

FOR	READ AS
10 th JANUARY 2025 (FRIDAY) 11:30HRS	15 th JANUARY 2025 (WEDNESDAY) 15:30HRS

2. The following terms of the subject tender is amended as follows:

FOR	READ AS
Annexure-II Clause: 2.1. Preparation of complete detailed design, calculations and detailed shop fabrication drawings based on the concept drawings and submit for approval.	Annexure-II Clause: 2.1. Preparation of detailed shop fabrication drawings based on the concept drawings and submit for approval.
2.4. No detailed shop drawings will be accepted for examination by the Engineer-in-charge unless these have first been completely checked and vetted by the contractor's qualified structural engineer. The qualified Structural Engineer Should be M. E /M tech in structural engineering with minimum 5 years' experience and must have handled structural design of steel structures. The structural engineer should certify the structural soundness and safety/stability of the moving shed structures	2.4. No detailed shop drawings will be accepted for examination by the Engineer-in-charge unless these have first been completely checked and vetted by the Chartered Engineer.

3. Bottom beam drawing enclosed.

4. Revised Price bid format enclosed as Annexure- V/A.

5. All the other terms and conditions of the tender enquiry remains unchanged.



For Udupi Cochin Shipyard Limited,

Assistant General Manager (Materials & Contract Cell)

सोणि क्लेमेन्ट टी एम
SONY CLEMENT T M

सहायक महाप्रबंधक/ASSISTANT GENERAL MANAGER
उडुपि कोचीन शिपयार्ड लिमिटेड
UDUPI COCHIN SHIPYARD LIMITED
माल्पे, कर्नाटक/MALPE, KARNATAKA-576 108



UDUPI COCHIN SHIPYARD LIMITED

Tender for Movable Shed Fabrication & Erection Work
UCSL/CC/T/CIVIL/311 DT: 02nd January 2025**UCSL/CC/T/CIVIL/311 DT: 02ND JANUARY 2025****TENDER FOR MOVABLE SHED FABRICATION & ERECTION WORK****REVISED PRICE BID FORMAT**

Sl. No	Description of items	Unit	Quantity Per Shed	Rate (Rs)	Amount (Rs)
1	<p>Structural tubular Frames: Steel work in built up tubular sections YST 310 grades as per IS: 4923 including cutting, hoisting, erecting in position, aligning the erected structures in line and level, bolting or welding wherever required as per drawing. complete with Hot finished seamless type tubes including painting applying two coats of aliphatic acrylic PU paint over two coats of epoxy cured with aliphatic amine over two coats of epoxy phenylkamine primer, etc. closing all the open ends properly with same material, cost and conveyance of all materials, all accessories, hire charge of tools and plants, welding equipment, cost of electrodes, cost of bolts, nuts and washers all labour, other incidentals, etc. complete. (Provision of bolt holes to be made as required at no extra cost). All as per the drawings, technical specification and as directed by Engineer.</p>	kg	15198		
2	<p>Bottom Beam and other structural members: Structural steel work bolted or welded in built up sections, trusses and framed work including cutting, hoisting, fixing in position and applying two coats of aliphatic acrylic PU paint over two coats of epoxy cured with aliphatic amine over two coats of epoxy phenylkamine primer, etc. including cost and conveyance of all materials, all accessories, hire charge of tools and plants, welding equipment, cost of electrodes, cost of bolts, nuts and washers all labour, other incidentals, etc. complete. (Provision of bolt holes to be made as required at no extra cost). All as per the drawings, technical specification and as directed by Engineer</p>	kg	2525		



UDUPI COCHIN SHIPYARD LIMITED

 Tender for Movable Shed Fabrication & Erection Work
 UCSSL/CC/T/CIVIL/311 DT: 02nd January 2025

Sl. No	Description of items	Unit	Quantity Per Shed	Rate (Rs)	Amount (Rs)
3	END STOPPER: Supplying and fabricating end stopper using Structural steel work bolted or welded in built up sections and framed work including cutting, hoisting, fixing in position and applying two coats of aliphatic acrylic PU paint over two coats of epoxy cured with aliphatic amine over two coats of epoxy phenylkamine primer, etc. including cost and conveyance of all materials, all accessories, hire charge of tools and plants, welding equipment, cost of electrodes, cost of anchor bolts, nuts and washers all labour, other incidentals, etc. complete. (Provision of bolt holes to be made as required at no extra cost). All as per the drawings and as directed by Engineer.	kg	100		
4	Supplying and fixing in position tamarind / thambogum its equivalent wooden plunger of size 350x200x150mm on end of each movable shed including cost and conveyance of all materials, cost of bolts, nuts and washers, all labour, other incidentals etc. complete.	Nos	5		
ROOFING WORKS					
5	Providing and fixing precoated galvanized iron profile sheets (size, shape and pitch of corrugation as approved by Engineer-in-charge) 0.50 mm (+ 0.05 %) total coated thickness with zinc coating 120 grams per sqm as per IS: 277, in 240 mpa steel grade, 5-7 microns epoxy primer on both side of the sheet and polyester top coat 15-18 microns. Sheet should have protective guard film of 25 microns minimum to avoid scratches during transportation and should be supplied in single length upto 12meter or as desired by Engineer In- charge. The sheet shall be fixed using self-drilling /self-tapping screws of size (5.5x 55 mm) with EPDM seal, complete upto any pitch in horizontal/ vertical or curved surfaces, excluding the cost of purlins, rafters and trusses and including cutting to size and shape wherever required.	Sqm	506		



UDUPI COCHIN SHIPYARD LIMITED

 Tender for Movable Shed Fabrication & Erection Work
 UCSSL/CC/T/CIVIL/311 DT: 02nd January 2025

Sl. No	Description of items	Unit	QTY	Rate (Rs)	Amount (Rs)
6	Providing and fixing precoated galvanized steel sheet Ridges plain (500 - 600mm) 0.50 mm (+ 0.05 %) total coated thickness, Zinc coating 120 grams per sqm as per IS: 277, in 240mpa steel grade, 5-7 microns epoxy primer on both side of the sheet and polyester top coat 15-18 microns using self-drilling/ self-tapping screws complete:	m	9		
7	Providing and fixing precoated galvanized steel sheet Gutter 600mm over all girth) 0.50 mm (+ 0.05 %) total coated thickness, Zinc coating 120 grams per sqm as per IS: 277, in 240 mpa steel grade, 5-7 microns epoxy primer on both side of the sheet and polyester top coat 15-18 microns using self-drilling/ self-tapping screws.	m	17		
8	Providing and fixing precoated galvanized steel sheet Flashings/ Aprons. (Upto 600 mm) 0.50 mm (+ 0.05 %) total coated thickness, Zinc coating 120 grams per sqm as per IS: 277, in 240 mpa steel grade, 5-7 microns epoxy primer on both side of the sheet and polyester top coat 15-18 microns using self-drilling/ self-tapping screws.	m	17		
9	Providing and fixing PVC rain water pipes 110 mm dia. - 4 kgf/cm ² to the correct line and level, using MS clamps. including cost and conveyance of all materials complete. All as directed by the Engineer	m	65		
10	Supplying and fixing forged / cast steel Idler wheel, of Size 345 mm OD X 300 mm Dia rim X 52 mm Bore X 100 mm Thick. Outer surface of Rim Hardened to 280-320 BHN up to 10 mm depth and of material conforming to IS 1570 to line and level. Including fabricating and erecting in position by welding / bolting including cost and conveyance of all materials, cost of wheels, ball bearing, bolts, nuts and washers, cost of welding rods, hire charges of welding equipment's, consumables etc. complete. as per the technical specification and as directed by Engineer.	Nos	6		
11	Fabrication and fixing of rails in proper line and level on the foundation base plate including fixing of shim plates if required to maintain the level and all the consumables etc., complete.	Rmt	150		
12	BASIC AMOUNT:				
13	GST%:				
14	GRAND TOTAL AMOUNT:				

i) The rates quoted should be all inclusive and shall include the service charges and other incidental expenditures, if applicable.

ii) Quotes with Conditional rates/additional charges/Conditional discounts will be disqualified.

 iii) **The above quantity is for one shed only; the total number of sheds is seven (07).**

iv) L1 will be determined based on the serial no.014.

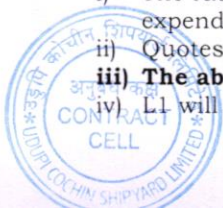

UDUPI COCHIN SHIPYARD LIMITED

Tender for Movable Shed Fabrication & Erection Work
UCSL/CC/T/CIVIL/311 DT: 02nd January 2025

B. PROVISIONAL ITEMS. THESE ITEMS SHALL NOT BE CONSIDERED FOR THE PURPOSE OF ARRIVING GRAND TOTAL AND DECIDING AT THE L 1 BIDDER.

Sl No:	Description of items	Unit	QTY	Rate (Rs)	Amount (Rs)
1	Drive Wheel assembly with forged / cast steel wheel, of Size 345 mm OD X 300 mm Dia rim X 52 mm Bore X 100 mm Thick. Outer surface of Rim Hardened to 280-320 BHN up to 10 mm depth and of material conforming to IS 1570 to line and level and Geared Motor (3 Phase, Maximum 2 HP, 6 Pole 960 RPM VFD Compatible Flange mounted Approved make Brake Motor.) Including supply, fabricating and erecting in position by welding / bolting including cost and conveyance of all materials, cost of wheels, ball bearing, gear, motor, shaft, bolts, nuts and washers, cost of welding rods, hire charges of welding equipment's, consumables etc. complete. as per the technical specification and as directed by Engineer.	Nos	4		
2	Supply, installation and commissioning of all electrical items including panels with switch gears, VFD etc complete with internal wiring and external wiring from panel to motors. Also, vendor to include multicore flexible copper stranded cable of suitable capacity of approx. Length of 30m for incoming to panel etc. complete. as per the technical specification and as directed by Engineer.	Nos	1		



Signature:

Date:

Address of the contractor:

Seal:

VIEW-A



CHS 100NB
x 5.4mm THK
WELDED TO MS PLATE

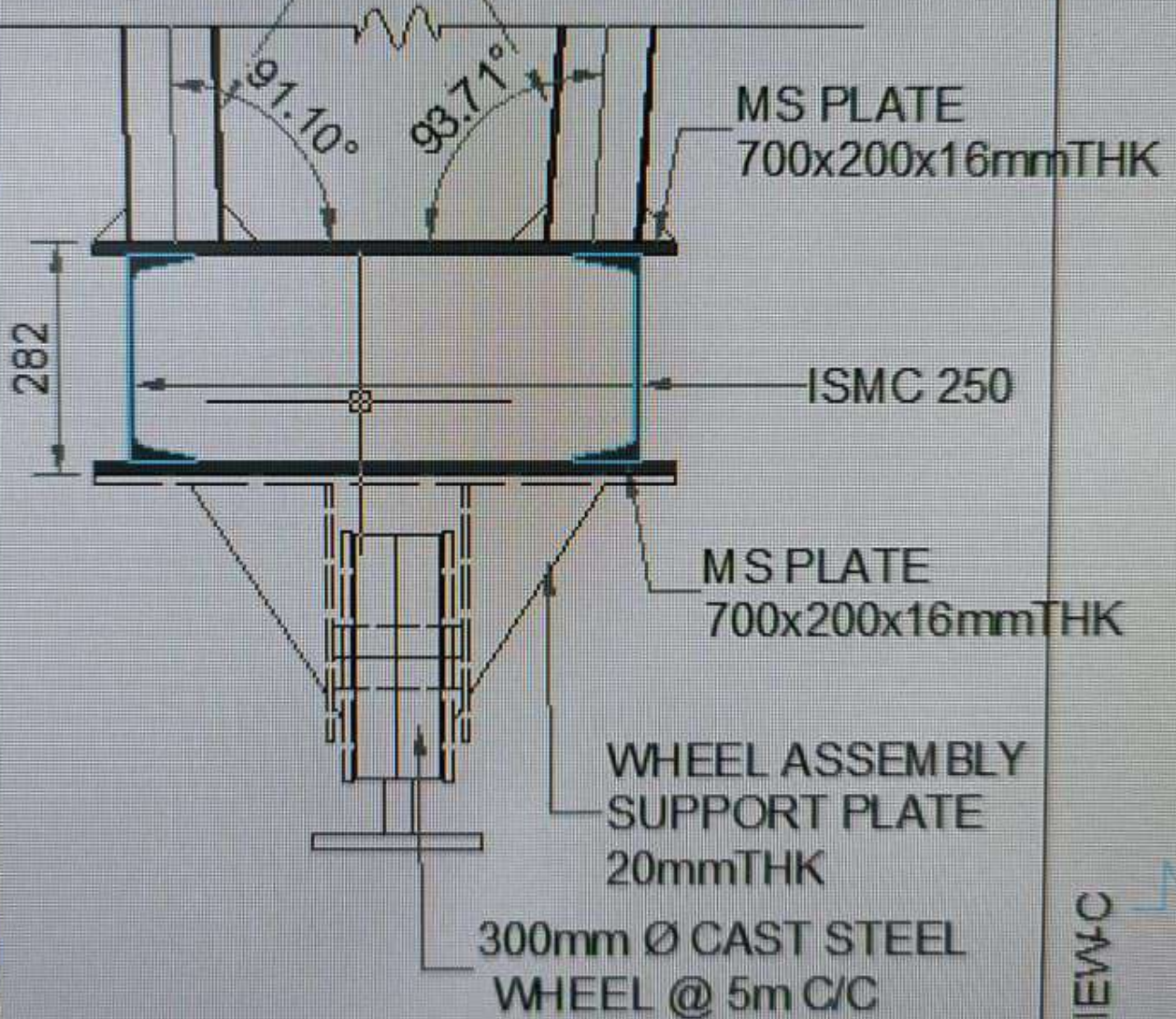

MS PLATE
700x200x16mm THK

ISMC 250

MS PLATE
700x200x16mm THK

WHEEL ASSEMBLY
SUPPORT PLATE
20mm THK

300mm Ø CAST STEEL
WHEEL @ 5m C/C

282

500 C/C (TYP)

VIEW-C

DETAIL-A

10mm THK PLATE
150mm WIDE

150

VIEW - C

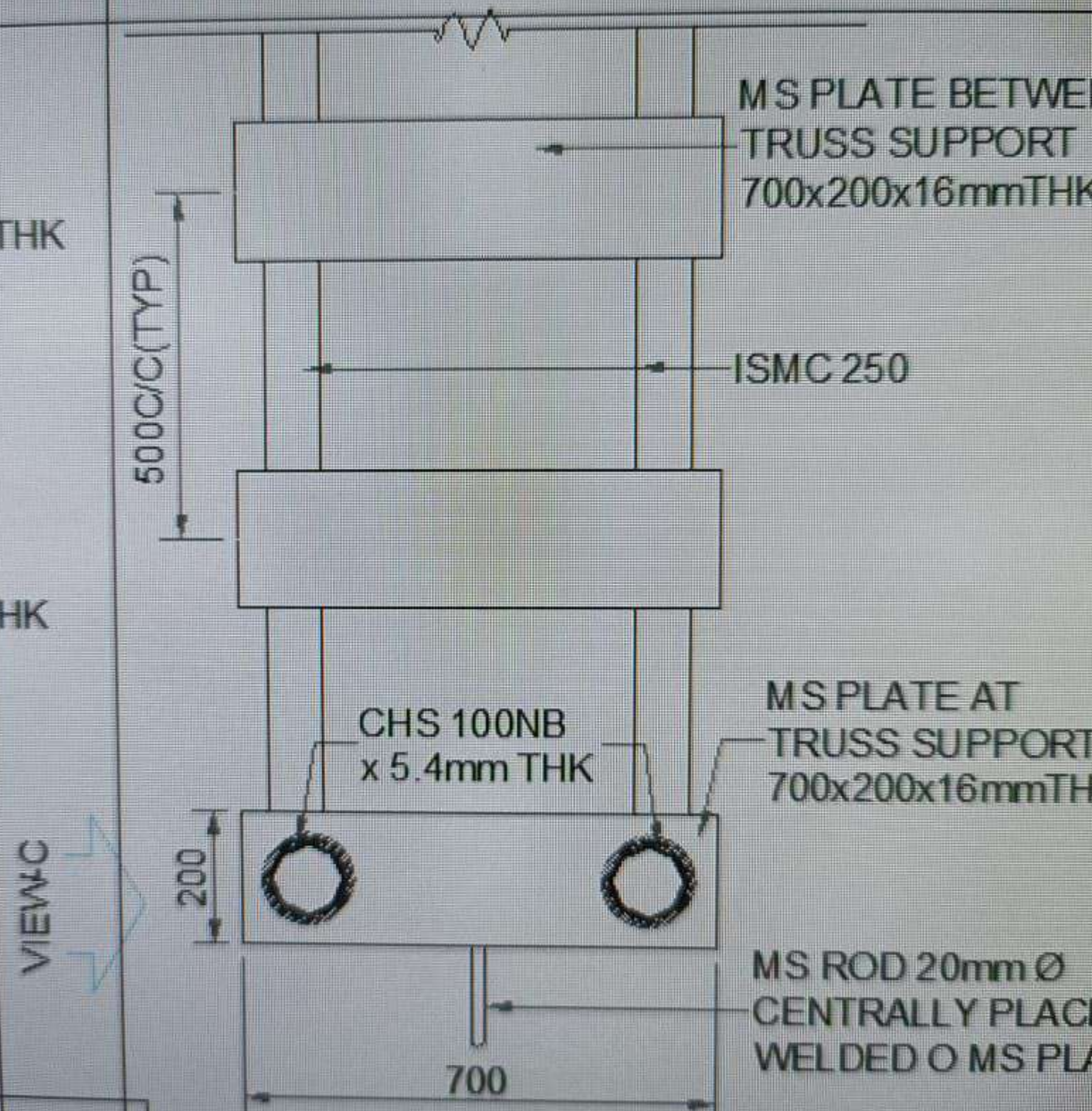

VIEW - A

THK PLATE
MDE